

1

2

3

4

Notes: (Unless Otherwise Specified)

- 1. RoHS Compliant.
- 2. 每250PCS用無Logo PE袋包裝, 並將標籤貼於袋外.

RR-52C10-16010\_REV:XX\_QTY:250PCS  
**LOT: XXXX**  
**Made in China**

- 3. 標籤上的REV: 請依照成品圖面版本.
- 4. 不可使用夾鍊袋.

REV	ECN#	DESCRIPTION OF REVISION	DRAW BY DATE	CHECK BY DATE	APPROVE BY DATE
A0		Mass Production	Lucas 10/09/18	Lucas 10/09/18	Ray 10/09/18

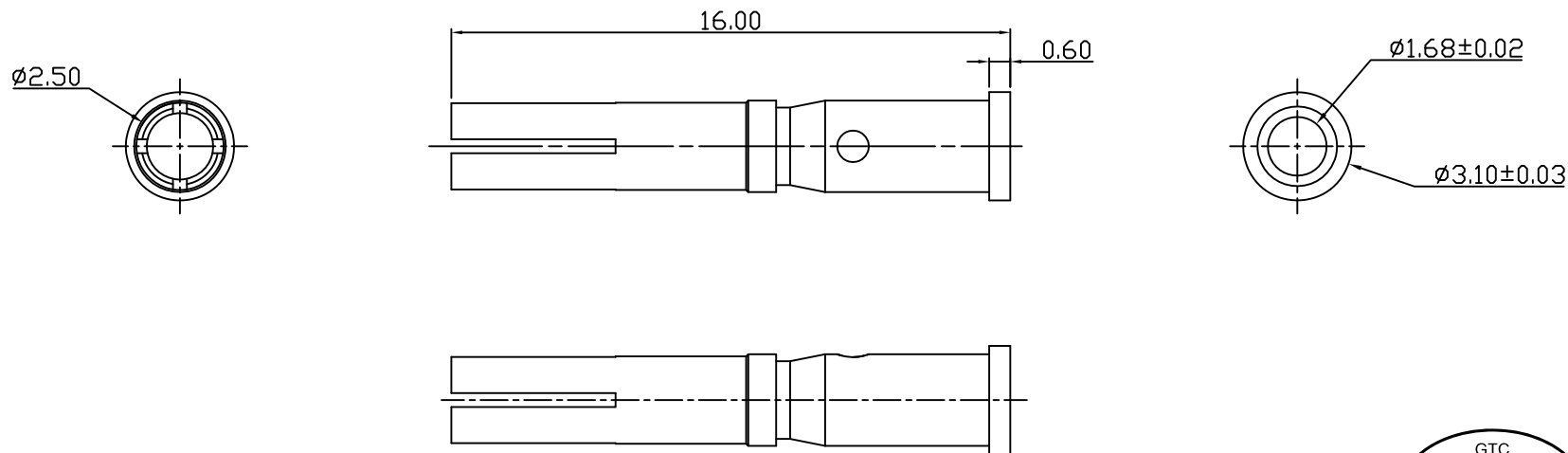

GTC  
 DOC.CENTER.ISSUE  
 OCT.09.2018  
 ONLY FOR  
 RELEASE

1	Contact	Copper Alloy Finish: Au Plated	1
Item	Part Name	Material / Finish	Q'ty

TITLE 10A Female Crimp Pin						DRAWING NUMBER RR-52C10-16010			REV. A0	
	B	8/1	Lucas 10/09/18	Lucas 10/09/18	Ray 10/09/18	All	$\pm 0.1$	ANGLES $\pm 1^\circ$	mm	1/1
THIRD ANGLE PROJECTION	SIZE	SCALE	DRAW / DATE	CHECK / DATE	APPROVE / DATE	TOLERANCES		UNIT	SHEET	

THE INFORMATION CONTAINED HEREIN IS THE PROPRIETARY INFORMATION OF RR BUSINESS VENTURES, LLC. THE POSSESSOR AGREES TO THE FOLLOWING:

1. MAINTAIN THIS DOCUMENT IN CONFIDENCE
2. NOT TO REPRODUCE OR COPY IT
3. NOT TO REVEAL OR PUBLISH IT IN WHOLE OR IN PART

COPYRIGHT © 2019

1

2

3

4

D

D

C

C

B

B

A

A